

## Streetscape and Landscape – Special Landscape for Key Design Features—the Indirect Left Turn

As illustrated in the Streetscape Zone diagram for Grant Road, there are a range of key roadway design features that will be highlighted by special landscape and streetscape features.

This board illustrates the key landscape design features associated with most of the road's Indirect Left Turns.

### Transit Plaza Concept

The intersection of Alvernon Way and Grant Road provides an opportunity for a transit plaza to serve as a community gathering place and provide a waiting area for transit riders, a police kiosk or other appropriate facilities that could serve the community.

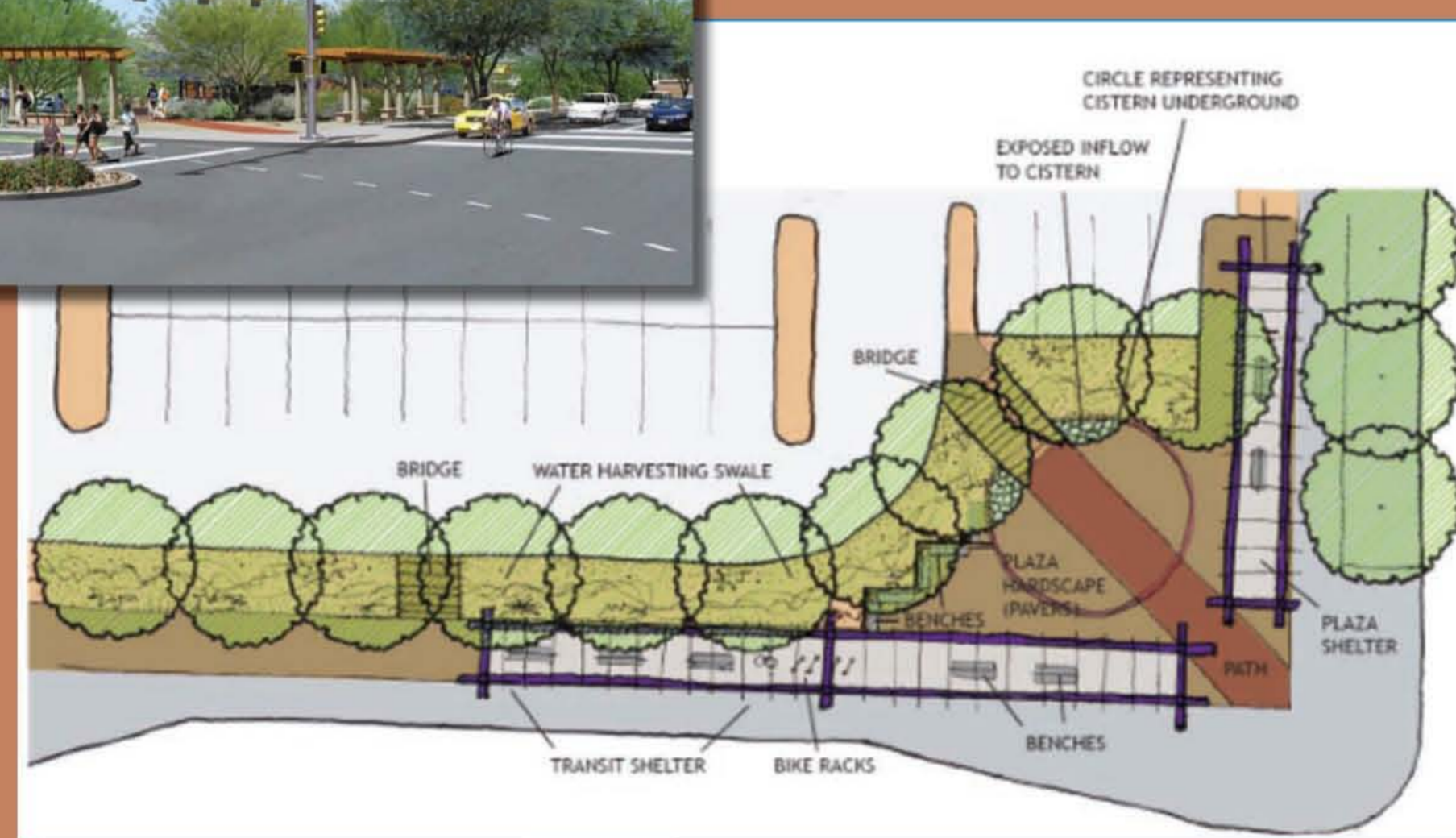

### Pedestrian Crossing at Indirect Left Turn Intersections

One benefit of the Indirect Left Turn is that it reduces the length of crossings. Landscaped medians and turn-lane islands also provide opportunities for pedestrian refuges, breaking crossings into a series of shorter lane crossings.



### Landscape Palette for Indirect Left Turn at Wide Median

A special landscape treatment will be provided at the major intersection and turn arounds of the Indirect Left Turn. This will be a repeating design element along the full length of the Grant Road improvements.

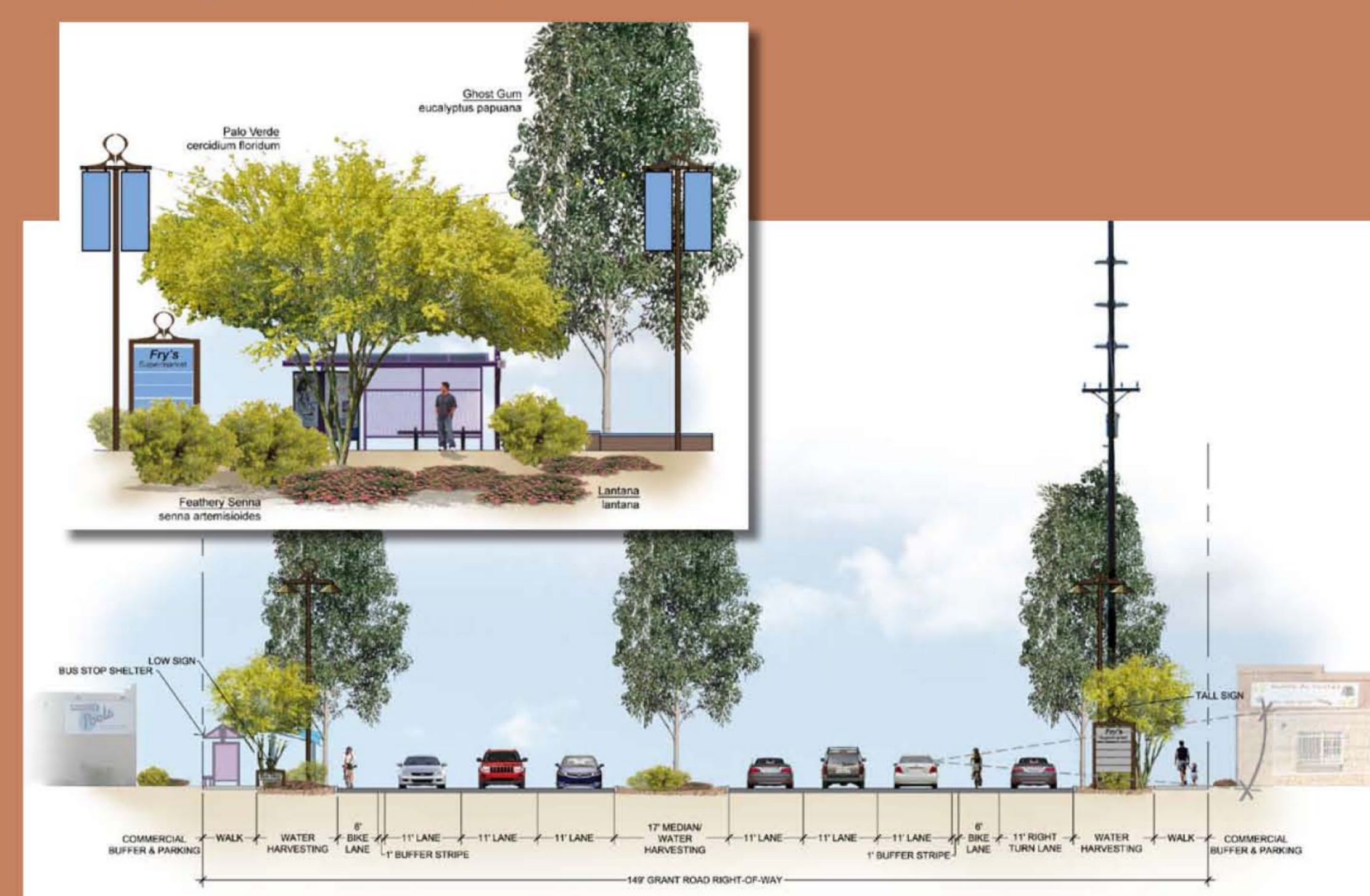

### Landscape Palette for Indirect Left Turn at Narrow Median

Medians as narrow as six feet are common around Tucson, but achieving the desired landscape quality for Grant Road is a challenge. This requires a design approach that maintains visibility at intersections and crossings, as well as providing for safe maintenance. The design concept proposes:

- Narrow plants, such as Saguaro and San Pedro Cactus
- Vertical public art elements or railings can also be provided

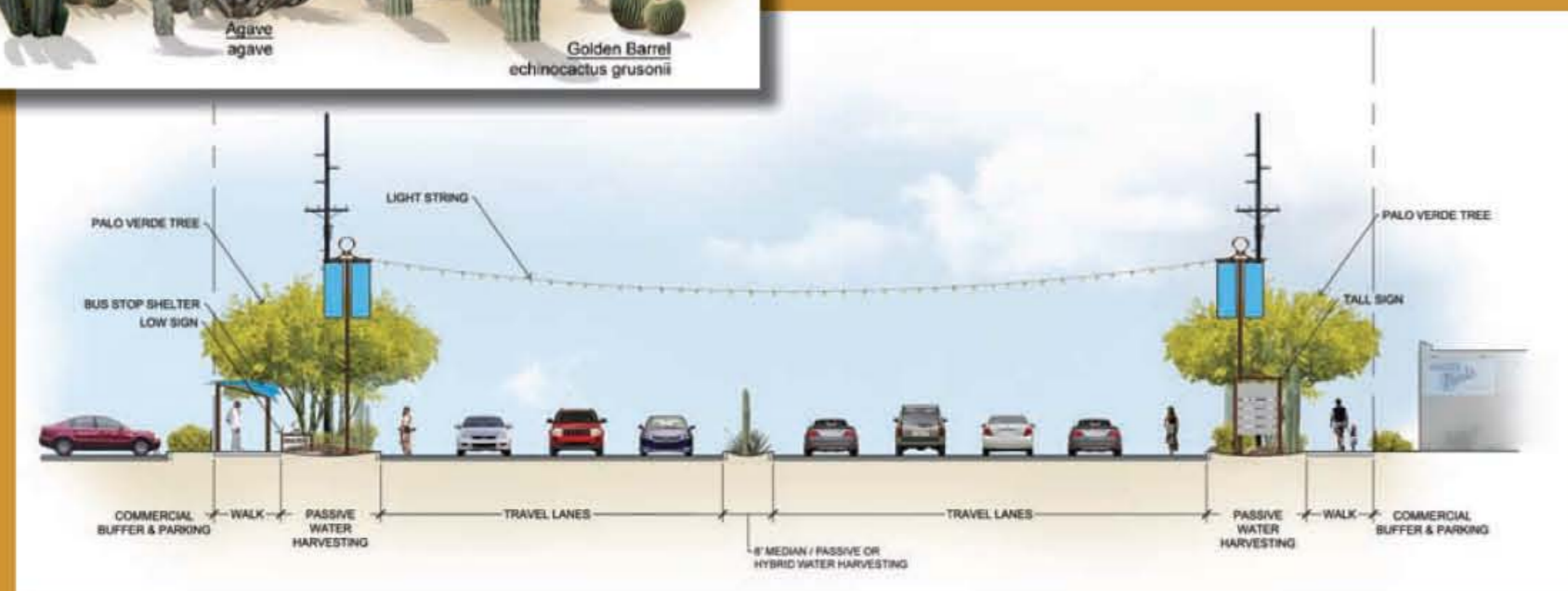
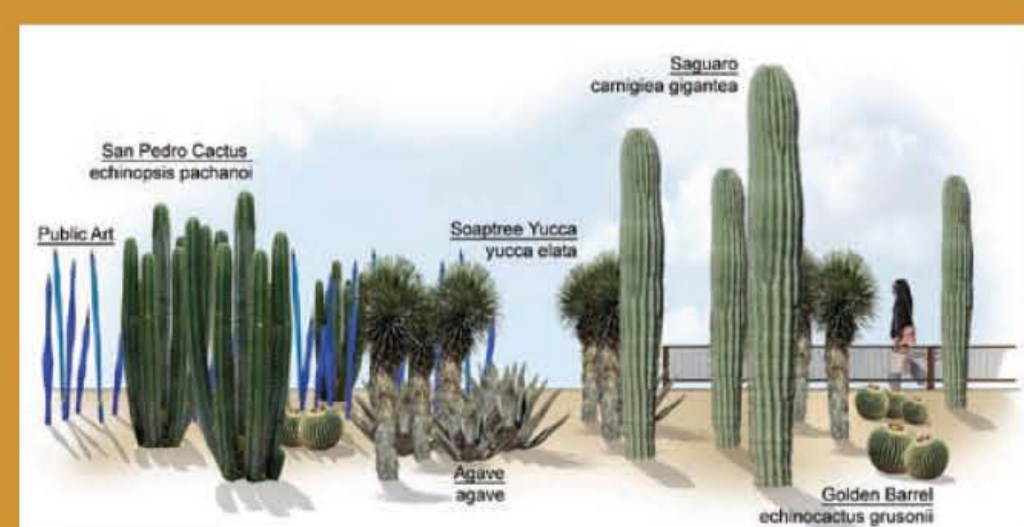

### Streetscape and Landscape Design at Enhanced Bus Stops

Particular attention has been given to developing a streetscape and landscape approach to the design of Grant Road's enhanced bus stops, because this supports the transit goals of the project. The design concept includes: landscaping and structures for shade, seating in addition to that in the bus shelter, and a high-level of pedestrian lighting to enhance security.

#### What people said in public outreach:

- Integrate public art with the bus stops, it can also discourage graffiti
- Provide public space adjacent to bus stops when possible
- Provide landscape for shade, but keep visually open to the street for security



### PELICAN Pedestrian Crossing at Indirect Left Turn Turnaround

PELICAN crossings provide new secure access across Grant Road. PELICANs also provide opportunities for marquee landscaping and shade structures for pedestrians when in the median of the roadway.



Existing Condition



Future Improvements - PELICAN Crossing